



**Wold Architects and Engineers**  
332 Minnesota Street, Suite W2000  
Saint Paul, MN 55101  
woldae.com | 651 227 7773

# **Schematic Design Submittal**

## **BLOOMING PRAIRIE HIGH SCHOOL ADDITION AND RENOVATION**

### **Independent School District #756**

Bloomington Prairie, Minnesota

February 22, 2022



<b><u>TABLE OF CONTENTS</u></b>	<b><u>PAGE</u></b>
INTRODUCTION	2
CORE PLANNING GROUP MEMBERS	3
GUIDING PRINCIPLES	4
CORE PLANNING GROUP'S DESIGN CRITERIA	5
SCHEMATIC SQUARE FOOTAGE	6-7
SITE PLAN	8
SCHEMATIC DESIGN FLOOR PLANS	9-12
OVERALL FLOOR PLAN	9
AUDITORIUM ADDITION	10
GYMNASIUM ADDITION	11
CLASSROOM ADDITION	12
PROJECT SCHEDULE	13



## **INTRODUCTION**

Wold Architects and Engineers is pleased to submit to the Board of Education of Independent School District #756 the Schematic Design Submittal for the Blooming Prairie High School Additions and Renovation. We wish to thank the Core Planning Group and the School District's Administration and Staff for the exhaustive efforts in providing the Design Team with the information necessary to advance to this state of development in a timely fashion.

The Design Team is commencing the Design Development Phase of this project. This report has been prepared to update the Board of Education. Thank you for the consideration of this design presentation.

---

Vaughn Dierks // AIA, LEED-AP  
Partner  
WOLD ARCHITECTS AND ENGINEERS



## **CORE PLANNING GROUP**

A Core Planning Group typically consists of members that are selected from a cross-section of the users of the facility, including parents, community members, staff, students, and other local stakeholders. The team is charged with the task of seeking input from the broader pool of Input Givers/Input Resources throughout the school district and community to develop the planning criteria.

## **CORE PLANNING GROUP MEMBERS**

Ali Mach	Stacy Magnus
Amy Ostrander	Bill Rinkenberger
Chris Staloch	Justin Kiehne
Gina Hendrickson	Matt Kittelson
Jacob Schwarz	Jesse Cardenas
Kari Bottin	Dennis Heimerman
Kayla Harvey	Rodney Krell
Lee Peterson	Bradley Simon
Sarah Oelkers	Melissa Stoen
Erik LaRock	Monica Anderson
Nate Piller	Kerie Olson
Ross Reishus	

## **CORE PLANNING GROUP MEETING DATES**

November 22<sup>nd</sup>, 2021  
December 20<sup>th</sup>, 2021  
January 3<sup>rd</sup>, 2022  
January 17<sup>th</sup>, 2022  
January 31<sup>st</sup>, 2022



## **CORE PLANNING GROUP GUIDING PRINCIPLES**

There should be a **balance between** separation and integration of **grade levels**.

The building should foster a **sense of community**.

The shared common spaces should be appropriate for all grades to learn and succeed in.

The building addition and renovation should **prioritize opportunities for natural daylight**.

The school should feel **cohesive in design**.

The building should meet the needs of today while providing for future flexibility and potential expansion

The new **auditorium and gym** addition should have a **“wow” factor**.

The building should function for programs both before and after school.

The design should provide a **variety of learning spaces** to promote flexibility and adaptability.

The layout of the building should be **easy to supervise** and **intuitive to navigate**.

Spaces used outside of school hours should be located for easy access and security.



## **CORE PLANNING GROUP DESIGN CRITERIA**

5<sup>th</sup> and 6<sup>th</sup> grade should have their own designated toilet facility near their classrooms, separate from the greater school community.

The **classroom wall into the flex** resources areas should be **2/3 transparent for visibility**.

Students should have some form of permanent student storage in the classroom.

There should be a **variety of seating options** for students to choose from in the commons and flexible resource areas.

The **play area** should be near the 5<sup>th</sup> and 6<sup>th</sup> grade classrooms.

General Music should be centrally located near the 5<sup>th</sup> and 6<sup>th</sup> grade classrooms.

The art rooms should be next to each other and near other specialty classes and **have windows for daylight**.

The new gym should be as near the main entry as possible.

Visiting teams should have a team room to use before, after, and during a game.

The **auditorium** should have a **separate entry** with a connection to the main entry/commons.

There should be a separate pathway to the auditorium for students/performers and for the public.

Main receiving should be relocated away from the main entry.

A custodial area should be located near the kitchen to accommodate a floor scrubber.

The media center should have **asynchronous learning zones** for all grade levels.

5<sup>th</sup> and 6<sup>th</sup> grades should have a zone for books dedicated to them, separate from the other books.

**All books** in the media center should **be securable**.



**Independent School District #756**  
 BLOOMING PRAIRIE HIGH SCHOOL ADDITION AND RENOVATION  
 February 22, 2022

AREA	November 2021 Review & Comment		February 2022 Schematic Design	
	Addition	Renovation	Addition	Renovation
<b>Classrooms</b>				
Classrooms (General)	4,800 SF		4,691 SF	
Support Spaces				
Group Areas / Flex Learning	1,000 SF	1,400 SF	1,000 SF	1,785 SF
Conference Rooms	400 SF		262 SF	
<b>Subtotal</b>	<b>6,200 SF</b>	<b>1,400 SF</b>	<b>5,953 SF</b>	<b>1,785 SF</b>
<b>Art</b>				
Labs	2,800 SF		2,634 SF	
Kiln / Storage	400 SF		0 SF	
<b>Subtotal</b>	<b>3,200 SF</b>		<b>2,634 SF</b>	
<b>Music</b>				
General Purpose		1,250 SF		1,250 SF
Choir		1,715 SF		1,715 SF
Band		1,645 SF		1,645 SF
Instrument Storage		155 SF		155 SF
Choir Office		290 SF		290 SF
Band Office		115 SF		115 SF
Practice		130 SF		130 SF
<b>Subtotal</b>		<b>4,050 SF</b>		<b>5,300 SF</b>
<b>CTE</b>				
Ag Lab		3,985 SF		3,985 SF
Woods		1,465 SF		1,879 SF
Classroom		850 SF		850 SF
<b>Subtotal</b>		<b>6,300 SF</b>		<b>6,714 SF</b>
<b>Physical Education</b>				
Auxiliary Gymnasium	14,000 SF		14,379 SF	
Fitness / Cardio / Flex		3,035 SF		3,029 SF
<b>Subtotal</b>	<b>14,000 SF</b>	<b>3,035 SF</b>	<b>14,379 SF</b>	<b>3,029 SF</b>
<b>Learning Commons / Media Center</b>				
Collection / Stacks / Secure (TBD)		2,345 SF		2,345 SF
Flex Learning (TBD)		1,935 SF		1,935 SF
<b>Subtotal</b>		<b>4,280 SF</b>		<b>4,280 SF</b>
<b>Cafeteria / Commons</b>				
Expansion	1,155 SF		1,190 SF	
<b>Subtotal</b>	<b>1,155 SF</b>		<b>1,190 SF</b>	
<b>Receiving / Building Storage</b>				
Receiving		770 SF	766 SF	323 SF
<b>Subtotal</b>		<b>770 SF</b>	<b>766 SF</b>	<b>323 SF</b>

SCHEMATIC SQUARE  
 FOOTAGE  
 SD 6



**Independent School District #756**  
 BLOOMING PRAIRIE HIGH SCHOOL ADDITION AND RENOVATION  
 February 22, 2022

AREA	November 2021 Review & Comment		February 2022 Schematic Design	
	Addition	Renovation	Addition	Renovation
<b>Performing Arts</b>				
Stage	3,000 SF		3,038 SF	
House / Seating (450)	6,750 SF		5,824 SF	
Dressing Rooms		3,035 SF	372 SF	0 SF
Make-up Room		incl SF	651 SF	0 SF
Toilets		incl SF	105 SF	0 SF
Scene Shop / Storage	800 SF		989 SF	
Control Room	225 SF		136 SF	
Lighting Platform	200 SF		136 SF	
Concessions / Tickets	200 SF		141 SF	
Lobby	1,000 SF		731 SF	
<b>Subtotal</b>	<b>12,175 SF</b>		<b>12,123 SF</b>	
<b>TOTAL NET SQUARE FOOTAGE</b>	<b>36,730 SF</b>	<b>22,870 SF</b>	<b>37,045 SF</b>	<b>21,431 SF</b>
<b>NET TO GROSS FACTOR</b>	<b>N/A</b>	<b>N/A</b>	<b>N/A</b>	<b>N/A</b>
(Includes mechanical, electrical, public toilets, circulation, and maintenance / janitorial spaces)				
<b>TOTAL GROSS SQ FOOTAGE</b>	<b>48,186 SF</b>	<b>SF</b>	<b>48,403 SF</b>	<b>SF</b>

SCHEMATIC SQUARE  
 FOOTAGE  
 SD 7



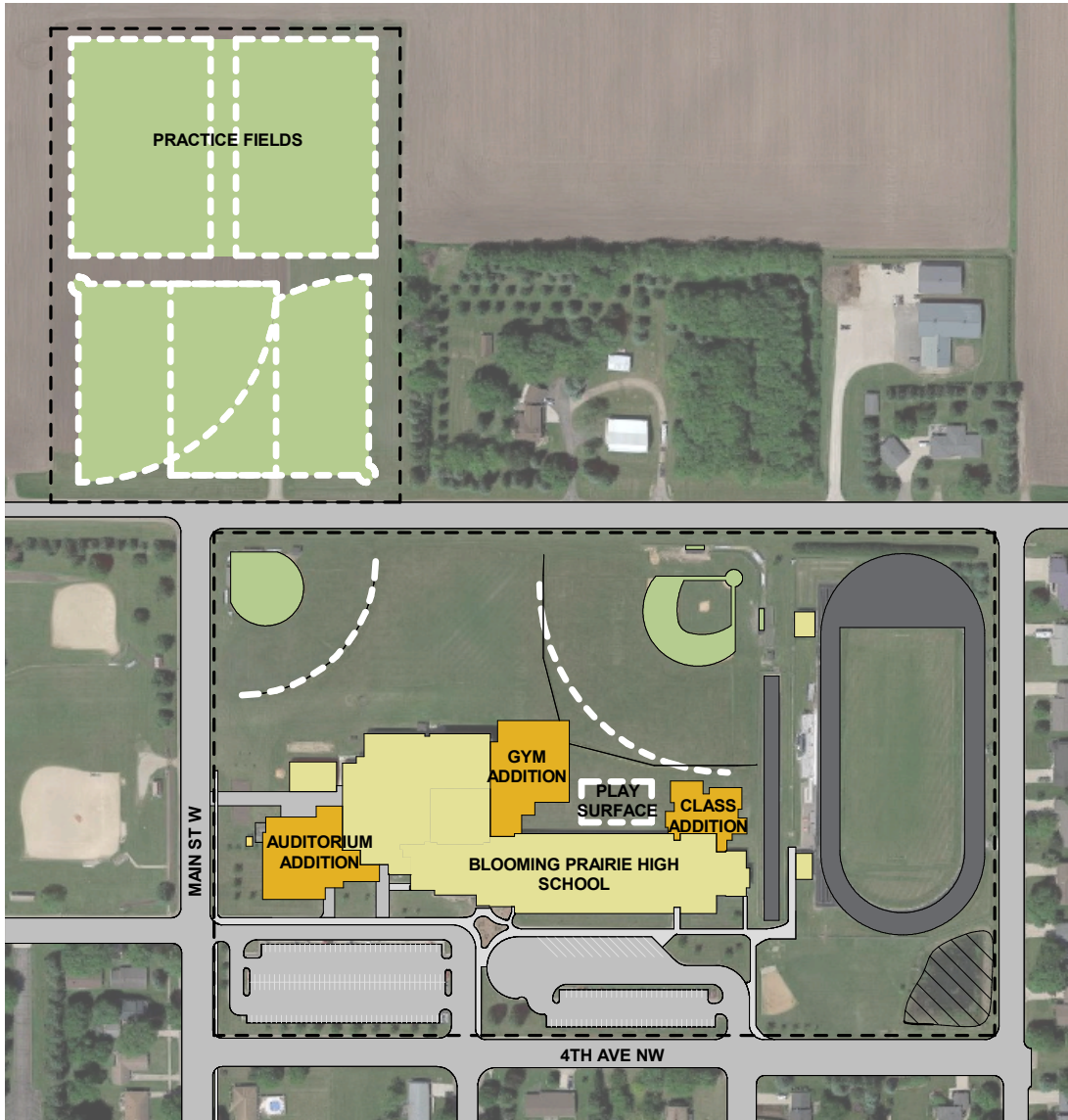











**1 SITE PLAN - PROPOSED**  
 1" = 300'-0"  
 0 225' 450'



**COLOR KEY**

- |   |                    |   |                     |
|---|--------------------|---|---------------------|
|  | PERFORMING ARTS    |  | SPECIALTY CLASSROOM |
|  | SPECIAL EDUCATION  |  | PHYSICAL ED         |
|  | ADMINISTRATION     |  | KITCHEN             |
|  | COMMONS            |  | MEDIA CENTER        |
|  | CLASSROOM/RESOURCE |  | BUILDING SUPPORT    |

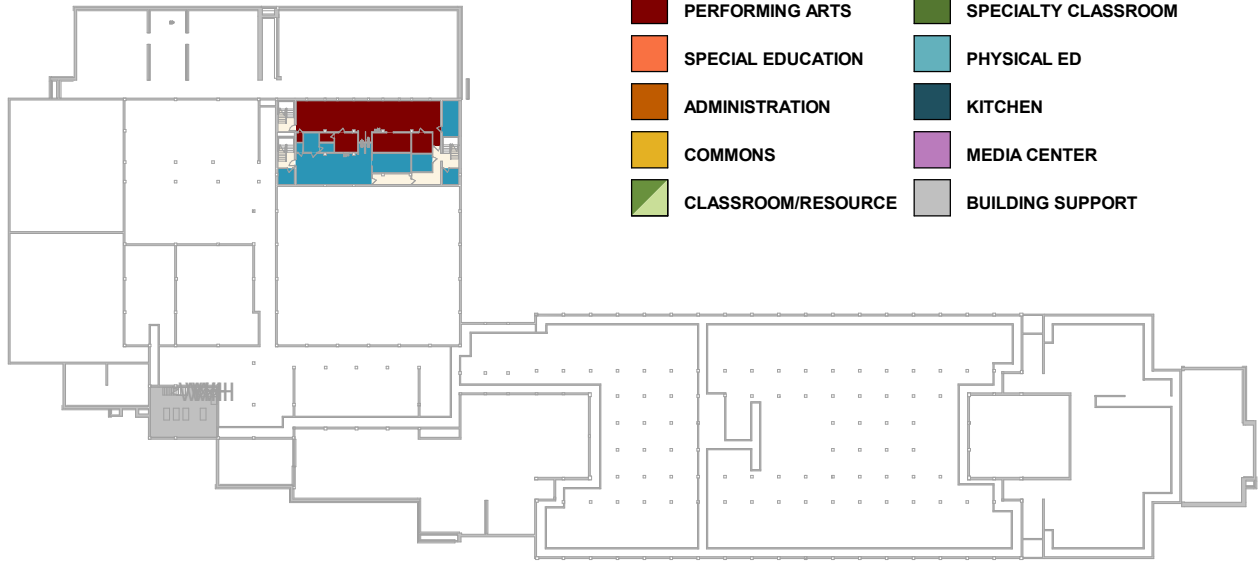

**2 LOWER LEVEL FLOOR PLAN - OVERALL**  
 1" = 100'-0"  
 0 75' 150'

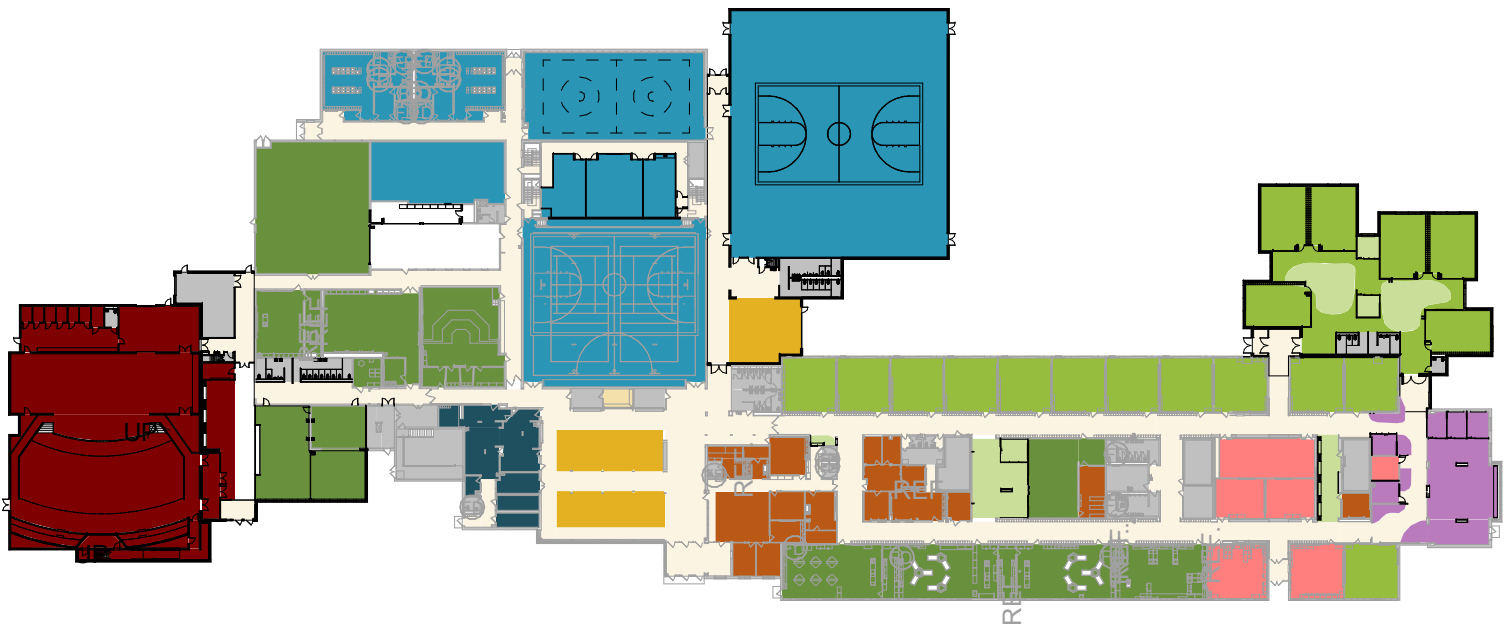

**1 MAIN LEVEL FLOOR PLAN - OVERALL**  
 1" = 100'-0"  
 0 75' 150'

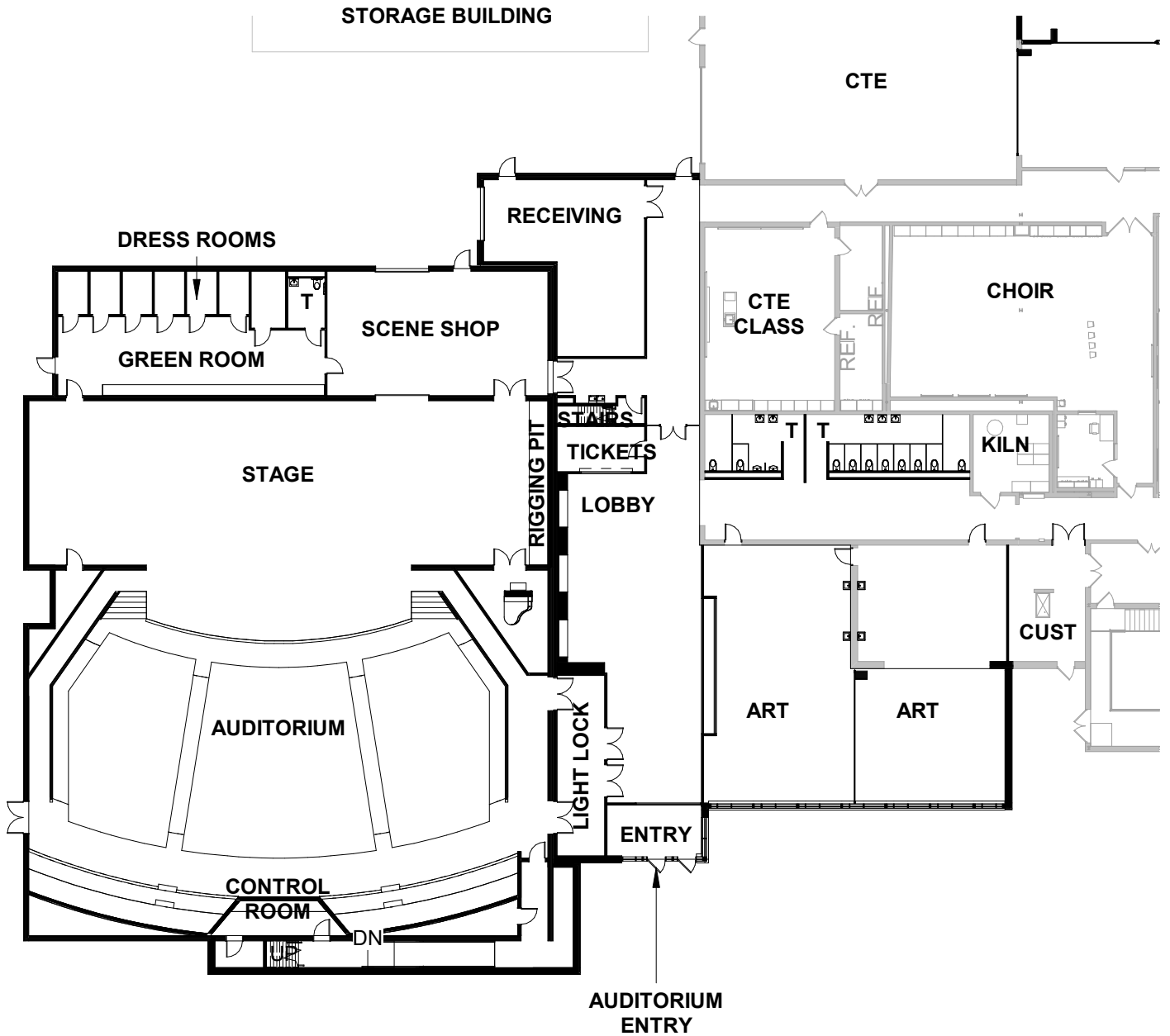

**1 21225 MAIN LEVEL FLOOR PLAN - AUDITORIUM & ART**  
 1" = 30'-0"  
 0 22'-6" 45'

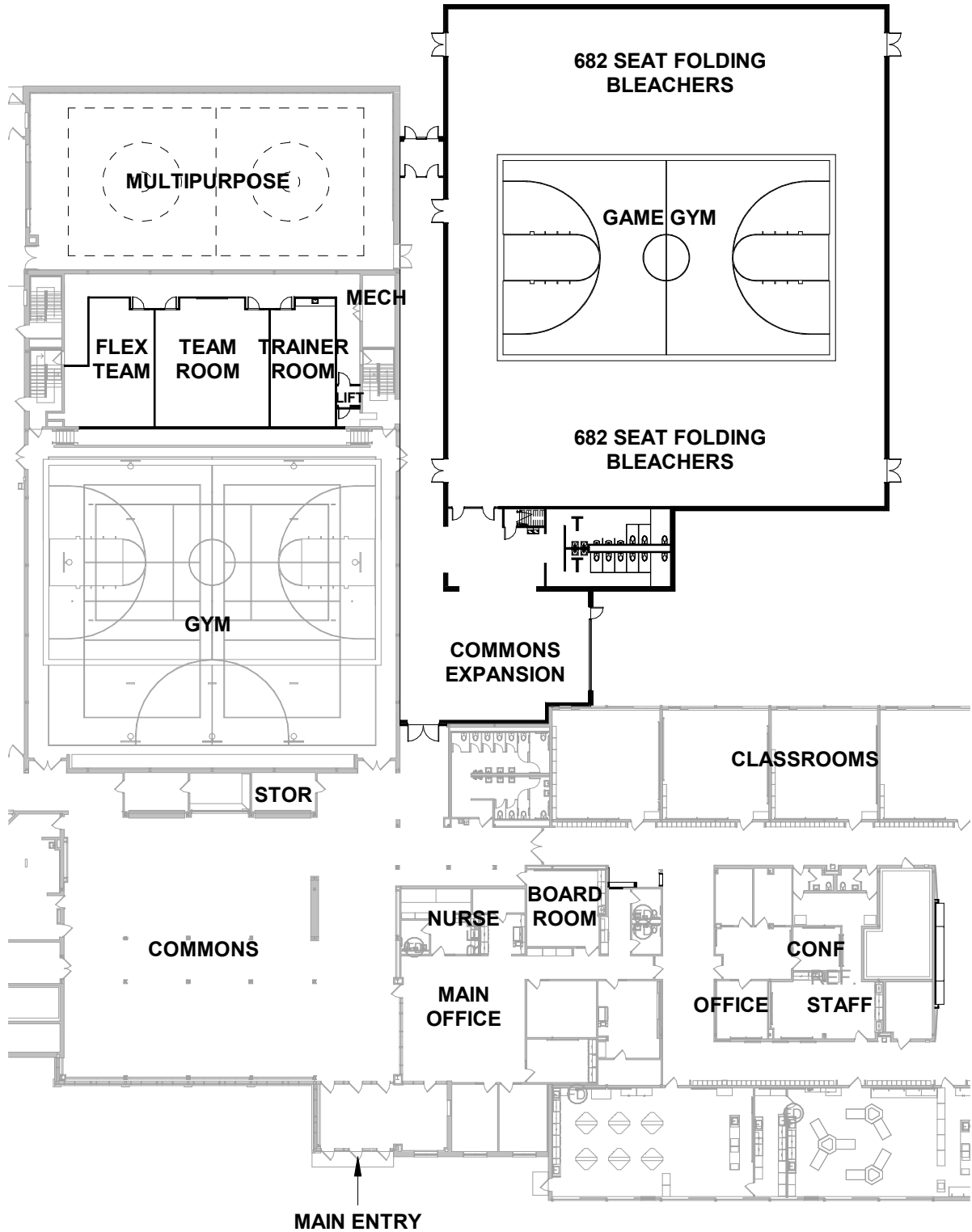

**1**

**212255 MAIN LEVEL FLOOR PLAN - GYM ADDITION**

1" = 40'-0"

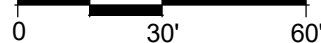

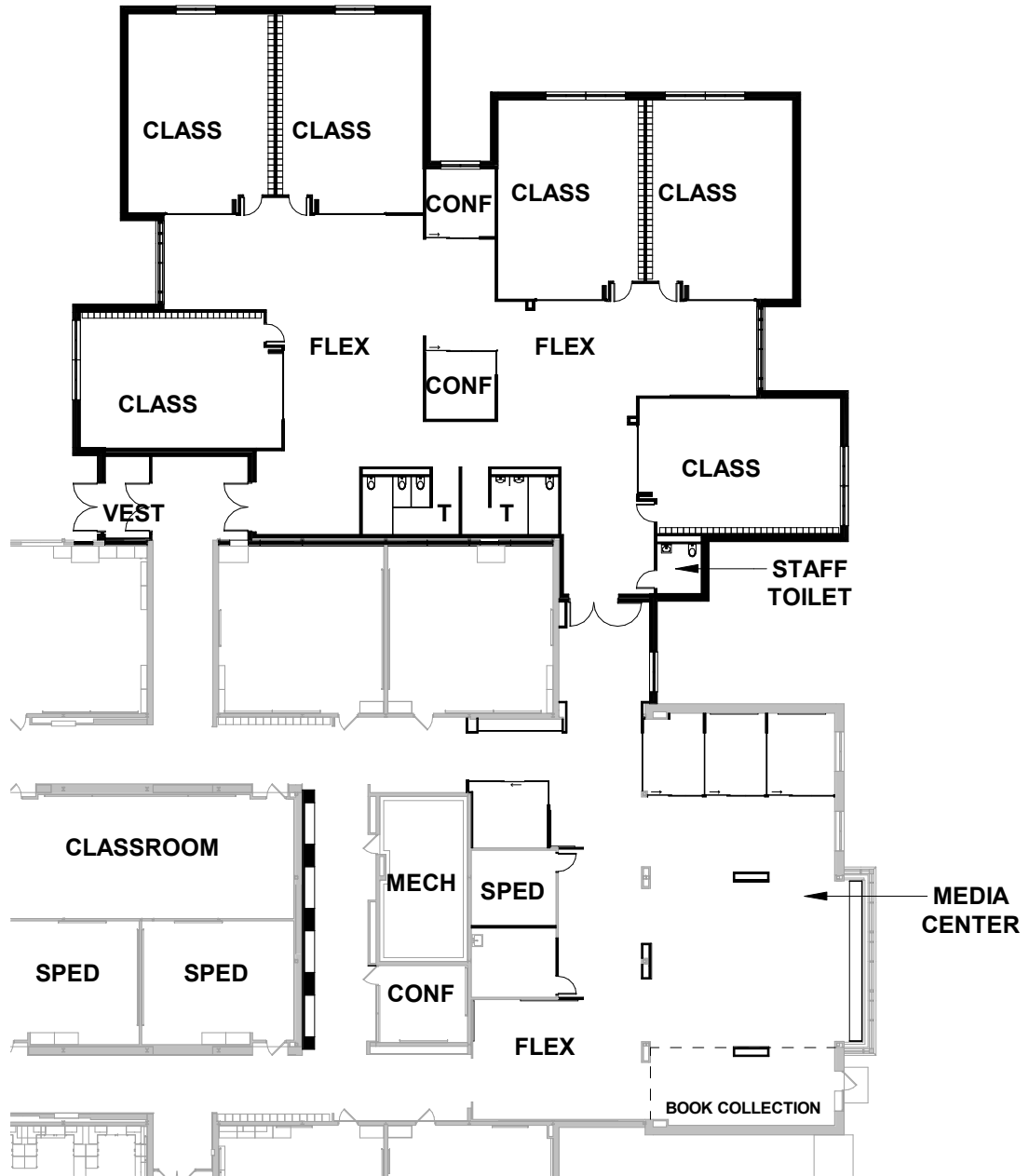

1

**212255 MAIN LEVEL FLOOR PLAN - MEDIA & CLASSROOM**

1" = 30'-0"

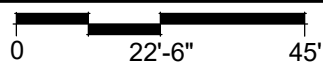



**BLOOMING PRAIRIE HIGH SCHOOL ADDITIONS AND RENOVATION**  
 SCHEMATIC PROJECT SCHEDULE

	2021												2022												2023											
	J	F	M	A	M	J	J	A	S	O	N	D	J	F	M	A	M	J	J	A	S	O	N	D	J	F	M	A	M	J	J	A	S	O	N	D
	1	2	3	4	5	6	7	8	9	#	#	#	#	#	#	#	#	#	#	#	#	#	#	#	#	#	#	#	#	#	#	#	#	#	#	#
<b>Blooming Prairie High School</b>																																				
Design																																				
Bidding																																				
Construction																																				
Punchlist / Furniture / Technology																																				
Occupancy																																				