



The Messenger

Minnesota
Educational Facility Management
Professionals

THE "TOOL BOX" FOR EDUCATIONAL FACILITY
MANAGEMENT PROFESSIONALS

INSIDE THIS ISSUE:

Conference Information	2
School Facilities Work Group	3
Flooring	4
Mole Management	5
Conference Information	6
Reference Cards	7
Conference Educational Session List	8
MASMS Memo Board	8

QUESTION:

**WHERE DO YOU NEED TO BE ON
OCTOBER 3RD & 4TH, 2013?**

ANSWER:

THE MASMS 2013 CONFERENCE

WHERE:

ST. CLOUD, MINNESOTA

WHY:

**WE EXPECT DOCTORS, LAWYERS AND
TEACHERS TO CONTINUE LEARNING ABOUT
THE LATEST INNOVATIONS, SOLUTIONS AND
RESEARCH IN THEIR FIELDS.**

**IT IS ABSOLUTELY CRITICAL FOR
SCHOOL FACILITY EMPLOYEES TO
DO THE SAME.**

**{success}
{trust}
{integrity}**

**THE BUILDING BLOCKS
OF THE 2013
MASMS CONFERENCE**

MASMS

Ruth Kraemer
Executive Administrator

Phone: 320-685-4585

Toll-Free:

888-429-3884

Fax: 320-685-4592

ruth@masms.org

To unsubscribe from
this newsletter, please
contact ruth@masms.org

CONFERENCE HIGHLIGHTS

41 EDUCATIONAL SESSIONS

(SEE BACK PAGE OF THE NEWSLETTER FOR A FULL LISTING)

"THE TRUST EDGE" KEYNOTE SPEAKER

150+ EXHIBITOR TRADE SHOW

GROUP IDEA EXCHANGE

CAPSTONE CLOSING SESSION

ROUND TABLE DISCUSSIONS

BANQUET-ENTERTAINMENT-PRIZES

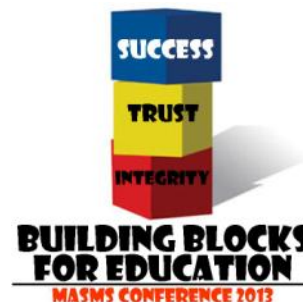

**FIND REGISTRATION FORMS ON THE MASMS WEB SITE: WWW.MASMS.ORG
OR CONTACT THE MASMS OFFICE AT 1-888-429-3884 OR [RUTH@MASMS.ORG](mailto:ruth@masms.org)**

2013 MASMS KEYNOTE SPEAKER

DAVID HORSAGER—THE TRUST EDGE!

David Horsager, M.A., C.S.P, is an author, entrepreneur, professor, and award-winning keynote speaker who researches and speaks on the bottom-line impact of trust. David's signature speech and nationally best selling book, *The Trust Edge*, have inspired leaders and motivated teams toward greater results on four continents and across the U.S.

DON'T MISS THIS SPEAKER! THURSDAY 10/3/13 AT 8:00 AM



NEW MASMS MEMBERS!

Business Members

Mark Driste, Summit Companies
Craig Jordan, Summit Companies
Jeff Buch, Victaulic

Educational Members

James Anderson, Eden Prairie Schools
Bret Mortenson, Canby Schools
Brian Haskin, Byron Schools

DESIGNER SIGN SYSTEMS

Serving Minnesota Schools for more than 20 years

Featured Product:

Evacuation Map Holder
Glow-In-The-Dark
Or Painted Options
Available

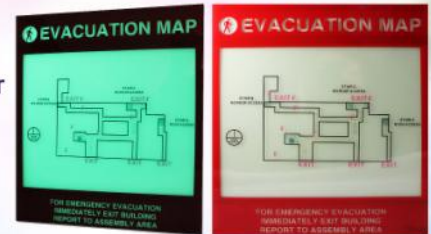

Vandal Resistant ADA Signage • Banners • Parking & Exterior Signage
Toll Free Phone: 1.866.784.5830 • www.designersign.com • DBE, SBE, WBE Certified

WE WERE THERE

Because your children's safety is priority number one.

When severe weather demanded quick decisions.

So facility management is never out of touch.



SALES: 952-808-0033
RENTALS: 952-890-7570
SERVICE: 952-808-7699

sales@ancom.org
WWW.ANCOM.ORG



MOTOROLA, MOTO, MOTOROLA SOLUTIONS and the Stylized M Logo are trademarks or registered trademarks of Motorola Trademark Holdings, LLC and are used under license. All other trademarks are the property of their respective owners. 2013 Motorola Solutions, Inc. All rights reserved.

Minnesota Department of **SCHOOL FACILITIES**
Education **FINANCING WORK**
GROUP

The commissioner of education (Dr. Brenda Cassellius), must convene a working group to develop recommendations for reforming the financing of preK-12 education facilities. This working group has been established by *Laws of Minnesota for 2014, Chapter 116, Article 6, section 9.*

They specifically came to MASMS, and asked for us to be part of this group. This is a unique moment in the "history" for MASMS to be asked to offer our expertise to the Legislature.

MASMS submitted five names of members that expressed interest in joining this group. The commissioner of education will select three names from that group.

We will keep MASMS membership informed as to who was selected and how the group is proceeding.

Laws of Minnesota for 2014, Chapter 116, Article 6, section 9, which reads as follows:

The commissioner of education must convene a working group to develop recommendations for reforming the financing of prekindergarten through grade 12 education facilities to create adequate, equitable, and sustainable financing of public school facilities throughout the state. Membership on the working group must include representatives of school superintendents, business managers, school facilities directors, and school boards. The scope of the working group recommendations must include funding options for facilities projects currently financed with debt service, alternative facilities, deferred maintenance, health and safety, building lease, and operating capital revenues. The commissioner, on behalf of the working group, must submit a report to the chairs and ranking minority members of the legislative committees and divisions with primary jurisdiction over kindergarten through grade 12 education finance by February 1, 2014, recommending how best to allocate funds for school facilities.



Outdoor Questions?



NaturalGreen is Your Answer!

NaturalGreen Services:

- Fertilization and Weed Control
- Lawn Care
- Landscape Design & Installation
- Irrigation Installation & Service
- Snow Removal & Ice Management
- Mulch Installation



Looking for networking opportunities?

The 2013 MASMS Conference is the place!

Advances in Flooring Make Installation and Maintenance Easier

Submitted by: Jen King, Patcraft

For both K-12 and higher education, flooring plays a key role in setting the tone and functionality for a space. In particular, advances in carpet tile, LVT and installation products are making it increasingly easier to meet design and performance requirements.

Carpet Tile

Carpet tile is the fastest growing product type in the commercial flooring industry. It's also an increasingly popular choice for dynamic learning environments throughout education facilities. Why? Because it is easy to install and repair, and it allows for numerous design configurations.



Carpet tile has long been valued for the ability to replace a small section of flooring or even a single tile as necessary due to staining or significant wear. The emergence of mergeable dye lots makes it even easier to mix and match replacement tiles over the course of time without worrying whether colors will match previous orders exactly. This also reduces the need to store significant amounts of replacement stock on-site.

And new generations of fiber can now ward off even the worst stain offenders (such as soda and red sports drinks) and can be cleaned up simply with water. This cationic fiber repels stains at the molecular level – meaning the stain-repelling features are built into the fiber rather than simply applied as a coating, which can wear off over time.

LVT / Resilient

Innovations in the manufacturing process have significantly improved LVT visuals. As increasingly realistic wood, stone and ceramic textures have entered the market, LVT's popularity has risen rapidly.

Today resilient flooring is being reinvented with its own design aesthetic – moving beyond mimicking other materials. This elevated aesthetic paired with outstanding performance and minimal maintenance requirements will accelerate the already high demand for resilient flooring. One of the biggest advantages is that LVT requires no waxing, saving significant time and money while still delivering high durability in the face of intense daily use.

Installation

Perhaps the biggest innovations in both carpet tile and LVT are related to installation.

Recently introduced non-wet systems for carpet tile and completely adhesiveless systems for LVT are gaining in popularity because they:

- Can be installed more quickly
- Are odor free, with low VOCs
- Require no set-up time for adhesive – no longer having a safety issue with an area cordoned off with wet adhesive
- Are more environmentally friendly – no left over buckets or glue to dispose of or recycle
- Tolerate a higher moisture / humidity level in the slab than traditional adhesive

Such flooring advances will continue to make maintenance and installation easier.

Mole Management Strategies

Moles can wreak havoc on lawns and athletic fields by digging surface-feeding burrows and building mole-hills. While most mole tunnels are deep underground, this surface activity results in an uneven turf surface and air pockets, which can kill turf.

Moles are small, sturdy mammals with grayish-brown, velvety fur that often has a silvery sheen. Their eyes have fused eyelids, which allow them only to distinguish light from dark. Living primarily underground, they use their snouts to feel and smell their environment and find food, which primarily consists of earthworms and other small invertebrates found in soil.



Moles are active throughout the year, except during extreme cold, heat or drought. They may become more active after rain or irrigation because tunnels are easier to dig in softer soil. Generally only one mole will inhabit a tunnel, except during breeding season.

Trapping can be effective for moles. Mole traps include scissor and harpoon traps; check local regulations to identify any restrictions. Place traps in existing tunnels, straddling the tunnel or hanging above it. Like many mammals, moles become suspicious when new objects are introduced into their environment. Set a plug of soil in the tunnel under the trap. Moles will burrow through the soil, treating it like a soil cave-in.

Before setting a trap, determine if the tunnel is still being used. Many surface burrows are used temporarily and then abandoned. Tamp down short sections of several surface runways. Make a note of the location of tamped down sections and check regularly. Sections that are raised again by the mole are likely in use. Deeper tunnels can be located by probing next to a fresh mound with a pointed stick or metal rod. You will feel the lack of resistance when you have struck a burrow. Keep in mind that mole traps will not be effective on rodents or other garden pests.

Research demonstrating effectiveness of repellants is sparse, particularly for large areas and athletic fields. Mole wheels, vibrating wind-mills and whistling bottles are available to discourage moles in gardens. There are also electrical devices that vibrate soil or produce sound. Mole repellents containing castor oil have been shown to be effective for eastern moles but little research has been done on other species. Monitor carefully when using repellents because they may simply drive moles to other nearby turf areas.

Grain-based toxic baits are rarely effective because moles typically eat earthworms and insects. Worm-shaped baits and gels that are squeezed directly into the tunnel are available.

For small areas such as gardens, exclusionary fencing is a temporary solution, although moles may eventually find a way in. Bury hardware cloth or 1/4-inch wire mesh in a trench at least two feet deep with a six-inch lip of mesh bent at a 90 degree angle away from the planting. Fencing should also protrude about six inches above the surface. Attempting to flood tunnels to drown moles or force them to the surface is generally ineffective. The large size of mole tunnel systems makes them very difficult to completely flood.

For more information on mole management, see the [Missouri University IPM Program](#) and the [University of California IPM Online](#).

ServiceMASTER
Clean

800-245-4622

24 hours a day
365 days a year

Disaster Clean Up...

- Pipe Breaks
- Sewage back-ups
- Sprinkler Head Breaks
- Vandalism
- Dumpster Fires
- Mold/Odor Damage
- Biohazard & Crime Scene
- Floods
- Tornadoes
- And More...



ServiceMaster Professional Services...

Provides coverage beyond the 26 counties we normally serve to include northern Minnesota. Utilizing a network of first responders, we are able to provide 2-4 hour response time anywhere in the state.

Promises expertise in commercial large losses, experienced project management, trained and uniformed crews with background checks already provided, and estimates utilizing insurance approved pricing.



Restoring
Peace of Mind

Certified Firm

www.servicemastercleanmn.com

2013 MASMS Conference Entertainment

Wednesday Evening 10/2/13—C. Willi Myles

A veteran performer and an extremely funny guy, C. Willi Myles has the gift of connecting people through humor and storytelling that everyone can relate to.



Thursday Evening 10/3/13—Home Free Vocal Band



A cappella. Technically it's what they do. But they are not your bow-tie barbershop quartet. They are a vocal band; which means they do more than sing – they recreate the entire band experience – engaging audiences in a rich blend of harmonies while entertaining them in good clean fun!

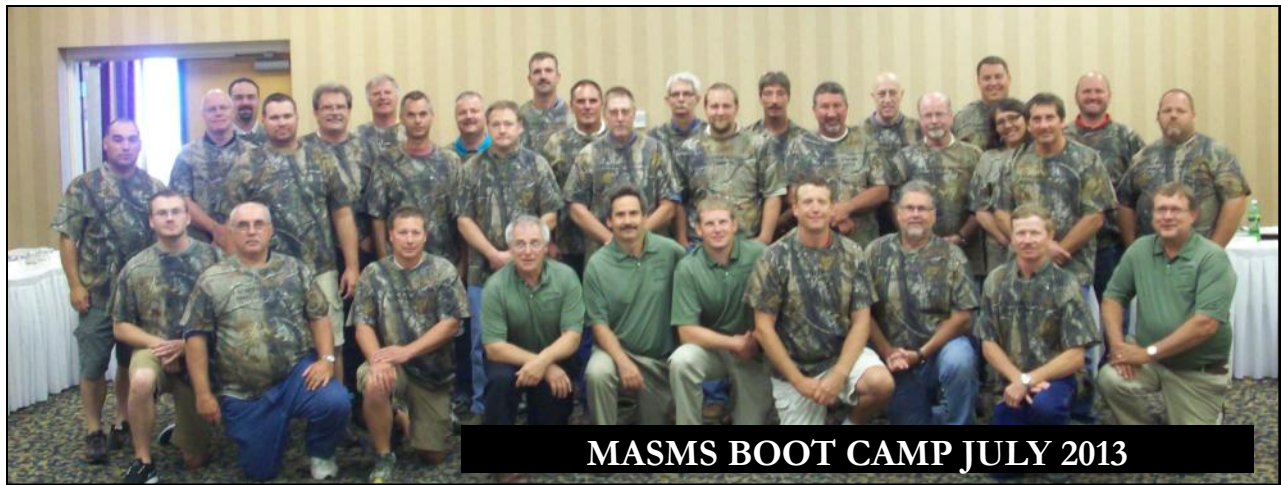

MASMS BOOT CAMP JULY 2013

WEDNESDAY OCTOBER 2, 2013

Join us at the Dollars for Scholars Golf Tournament—Wapicada Golf Course, Sauk Rapids, MN
Support the MASMS Scholarship Fund

MASMS gives over \$15,000 a year in scholarships to member's children!





Pavement Resources

SEALCOATING • PATCHING • SWEEPING • CRACKFILLING • STRIPING

Call today for a FREE Quote!
612.597.9995

www.pavementresources.com

Free reference card compares NFPA 704 and OSHA GHS labels...

When OSHA announced last year that it was updating its Hazard Communication Standard to include the adoption of the Globally Harmonized System of Classification and Labeling of Chemicals, many companies and emergency responders asked "How will this impact NFPA 704? NFPA 704, *Identification of the Hazards of Materials for Emergency Response*, uses a combination of color coding and numbers to describe a hazard's severity, and provides a simple, readily recognized, and easily understood label to assist those who are responding to an emergency such as a fire or spill. OSHA's revised Standard, known as Hazard Communication 2012 or [HC2012](#), is a workplace chemical information system established primarily to provide information and safe work practices for those working with chemicals on a routine basis through the use of labels, Safety Data Sheets (SDSs) and training.

The concern is that the HC2012 standard incorporates a numerical rating system that appears to be similar to NFPA 704 rating system, however the severity rating on the two standards are inverted. NFPA 704 uses a numerical of 0-4 with 4 indicating the *most severe* hazard. Hazard Communication 2012 uses a numerical rating system for classification of chemicals between 1-4 with a 4 rating indicating the *least severe* hazard. The inverse numerical rating between the two systems is primarily what creates the concern.

To address this concern, NFPA has been working with OSHA over the past year to promote awareness of the differences between the two systems. It should be noted that OSHA does not necessarily see a conflict between HCS and NFPA 704. OSHA has indicated that the GHS numbers are not relative ratings of hazards but are used for the purpose of classifying hazards into categories for proper labeling and training information. The numbers for GHS will be placed on the SDS but are not required to be on labels.

Recently OSHA and NFPA worked together to develop a Quick Card showing the differences between the two systems. The Quick card can be found on the NFPA Document information—web address: <http://www.nfpa.org/codes-and-standards/document-information-pages?mode=code&code=704>. At the bottom of the page under "Additional Information" you will see the link. The card can be downloaded and laminated as a two sided document that can be used for easy field reference.

The NFPA Technical Committee on Classification will continue to assess the impact of GHS incorporation into OSHA's HC2012 standard. In the meantime, there is no immediate plan to change the existing NFPA 704 system. The Committee recognizes that the NFPA 704 consensus standard has been protecting emergency responders, employees, and the public for over 50 years and any changes would need to be carefully considered. For updates on NFPA 704 it is recommended that you sign up for email alerts on the top of the document information page for [NFPA 704](#).

**Planning your summer projects? Don't forget
to water jet your drains, call (651) 436-3370**



unclogdrains.com
McDonough's
651.436.3370
Water Jetting - Drain Cleaning - Industrial Vacuuming



WATERJETTING



DRAIN CLEANING



INDUSTRIAL VACUUMING



OPTICAL INSPECTION

The MASMS Memo Board

MASMS Executive Board Members

PRESIDENT —MARK EISENBACHER, CAMBRIDGE-ISANTI SCHOOLS
 PRESIDENT ELECT—KEVIN JOHNSON, RED WING SCHOOLS
 VICE PRESIDENT —REED MCFARLANE, LAKE OF THE WOODS SCHOOLS
 PAST PRESIDENT —MAT MILLER, AUSTIN SCHOOLS

SECRETARY—VINCE ELKE, EDEN PRAIRIE SCHOOLS
 TREASURER—KEVIN HILDEBRANDT, FARIBAULT SCHOOLS
 VENDOR DIRECTOR: DAVE HOLM, SCANAIR

CHAPTER DIRECTORS:

NORTHERN—JOE ARTHURS, HIBBING SCHOOLS
 SOUTHERN—DAVE HAGEN, TRITON SCHOOLS
 METRO—DON HANSON, SOUTH WASHINGTON COUNTY SCHOOLS

MASMS CALENDAR

October 2, 2013 MASMS Scholarship Golf Event, Sauk Rapids, MN
 October 3 & 4, 2013 STATE CONFERENCE, St. Cloud, MN

CONFERENCE EDUCATIONAL SESSIONS FOR 2013

THE TRUST EDGE

"The single uniqueness of the greatest leaders of all time is Trust."

PLAYGROUND SAFETY

Safety, compliance, and maintenance.

WHAT MAKES A CONDENSING BOILER

Condensing boiler technology.

WHO'S MASTER PLAN IS IT?

Effective master planning can save money.

AIR & VAPOR BARRIERS

Learn how Air Barriers and Vapor Barriers are critical to saving energy.

MAINTAINING PAVEMENT

Options for Successful Maintenance.

LEADERSHIP ROLE

Leadership basics. How to run a meeting.

CARE OF CAFETERIA TABLES

Cleaning do's and don'ts.

HVAC FILTRATION

IEQ, Sustainability, and Operational Impacts of HVAC Filtration Options

NATURAL GAS RISK MGMT

Market Trends & Supply Options

ZERO PESTICIDE

MAINTENANCE BALL FIELDS

Turf management practices to minimize the use of herbicides, insecticides and fungicides.

OPTIONS FOR LOW INPUT LAWNS

ACTIVE SHOOTER IN A SCHOOL

WHERE IS THE LEAK COMING FROM?

Leak lessons from others' experience!

STATE OF MN ENERGY SAVINGS

Energy Savings Performance Contracting as a tool to implement Energy Efficiency

BEST PRACTICES IN WASTE PREVENTION & RECYCLING

IAQ CHALLENGES WITH POOLS

Discuss challenges that facility managers face in providing a healthy pool.

ADA REQUIREMENTS FOR BUILDING EXTERIORS

ADA issues you should know about for your buildings' exteriors and grounds.

MICROSOFT EXCEL BASICS

Learn the basics of MS Excel

INCORPORATING 21ST CENTURY SYSTEMS IN A 20TH CENTURY BUILDING

MICROSOFT POWERPOINT BASICS

FIRE DOORS & HEALTHY WALK THROUGH DOORS

What to know when servicing your doors.

GROUNDS CARE IN-HOUSE VS. CONTRACTING



**BREAKFAST
BUFFET & GROUP IDEA
EXCHANGE ON FRIDAY
MORNING!**

CAPSTONE SESSION

Friday October 4, 2013

DON'T MISS THIS CLOSING EDUCATIONAL SESSION

The impact of the building & grounds department. Taking pride in our work!

MINNESOTA ERK CHANGES

TO MEET OSHA HAZARD

COMMUNICATION STANDARDS

Covers the impact of this new standard on schools and provide direction

COOPERATIVE PURCHASING 101

TIPS & TRICKS FOR PAINTING

Aspects to solve your concerns with slippery floors and corrosion problems.

STORMWATER MANAGEMENT

A Stormwater Facilities Maintenance Program is necessary for ensuring that stormwater management facilities are properly inspected and maintained.

CRISIS MANAGEMENT 101

Concepts and basics involved in maintaining a crisis management program.

MAINTAINING AND PROTECTING YOUR CONCRETE FLOORS

Types of industrial coatings, sealers and stains that can be applied to concrete floors, walkways and pool decks.

Round Tables—Friday October 4th
These are Small Group Discussions

Topics:

- Electrical Safety/State Regulations
- Energy Conservation Programs
- Safety Committee Supporting the Educational Mission
- Boiler Operation -MASMS Certification
- Turf/Grass/Trees -Technology

**Classes qualify for AFE
Continuing Educational
Units and MASMS Certification**